



**CSE**

10-600 ton  
Stroke 50-250 mm  
700 bar

Series  
**CSE**

## High tonnage cylinders, single acting, load return



### High tonnage

- Single-acting high tonnage hydraulic cylinders with load return, high-pressure. Push force from 10 to 600 tons with range of strokes from from 50 mm to 250 mm.
- Hydraulic cylinders suitable for heavy-duty applications and for lifting, pushing and large lifting operations.
- The guiding surfaces are sized to guarantee optimal performance in load offset absorption and stop-ring increases safety for the operator avoiding the over stroke of the piston.
- Equipped with high strength gaskets for maximum durability.
- 3/8 " NPT female coupler with dust cap equipped.
- Removable high strength saddle and possibility of mounting a tilting saddle for better distribution of the load to be lifted.
- External painting and Nitox ONC treatment on all mechanical components for maximum resistance against corrosion and wear up to 30 ton models. 60 ton and higher capacity models feature a Nitox ONC treatment on all mechanical parts.
- All models weighing more than 20 kg are equipped with lifting eyebolts.
- Possibility to design and produce custom made hydraulic cylinders on request, with dedicated geometries, performances and features.

### CUSTOM CYLINDERS ON REQUEST

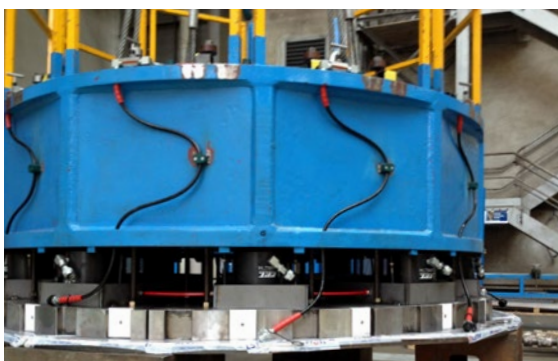

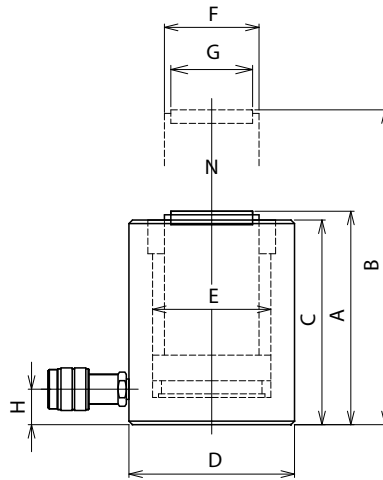

CSE

CAP/Force ton (kN)	STROKE mm	MODEL	SECTION cm <sup>2</sup>	VOLUME cm <sup>3</sup>	MASS kg	DIMENSIONS in mm							
						A	B	C	D	E	F	G	H
<b>10</b> /111,3	50	CSE-10/50	15,9	79,5	2	102	152	96	60	45	38	30	20
<b>20</b> /218,2	50	CSE-20/50	31,2	155,9	5	109	159	104	92	63	50	40	21
<b>30</b> /309,3	50	CSE-30/50	44,2	220,9	7,4	117	167	111	108	75	60	52	24
	100	CSE-30/100	44,2	441,8	10,4	167	267	161	108	75	60	52	24
<b>50</b> /549,8	50	CSE-50/50	78,5	392,7	14	129	179	123	140	100	80	72	30
	100	CSE-50/100	78,5	785,4	18,9	179	279	173	140	100	80	72	30
	150	CSE-50/150	78,5	1178,1	24,8	237	387	231	140	100	80	72	30
<b>100</b> /1077,6	50	CSE-100/50	153,9	769,7	29	142	192	136	190	140	118	92	34
	100	CSE-100/100	153,9	1539,4	38	192	292	186	190	140	118	92	34
	150	CSE-100/150	153,9	2309,1	52	261	411	255	190	140	118	92	34
<b>150</b> /1407,4	50	CSE-150/50	201,1	1005,3	46	170	220	164	218	160	130	110	37
	100	CSE-150/100	201,1	2010,6	58	220	320	214	218	160	130	110	37
	150	CSE-150/150	201,1	3015,9	71	274	424	268	218	160	130	110	37
	200	CSE-150/200	201,1	4021,2	90	347	547	341	218	160	130	110	37
<b>200</b> /1984,7	50	CSE-200/50	283,5	1417,6	67	192	242	186	258	190	150	138	47
	150	CSE-200/150	283,5	4252,9	96	292	442	286	258	190	150	138	47
	200	CSE-200/200	283,5	5670,6	117	357	557	351	258	190	150	138	47
<b>250</b> /2424,5	150	CSE-250/150	346,4	5195,4	154	328	478	322	290	210	170	148	52
	250	CSE-250/250	346,4	8659	206	447	697	441	290	210	170	148	52
<b>300</b> /2908,3	150	CSE-300/150	415,5	6232,1	168	325	475	318	308	230	180	158	57
	250	CSE-300/250	415,5	10386,9	222	440	690	433	308	230	180	158	57
<b>400</b> /4007,9	150	CSE-400/150	572,6	8588,3	270	362	512	355	365	270	220	196	67
	250	CSE-400/250	572,6	14313,9	337	462	712	455	365	270	220	196	67
<b>500</b> /4948	150	CSE-500/150	706,9	10602,9	333	374	524	367	400	300	240	214	72
	250	CSE-500/250	706,9	17671,5	429	492	742	485	400	300	240	214	72
<b>600</b> /5987,1	150	CSE-600/150	855,3	12829,5	422	387	537	380	440	330	270	244	82
	250	CSE-600/250	855,3	21382,5	540	505	755	498	440	330	270	244	82

Different strokes and tonnages available.